



**PRESENTS**

# **Airplane Suspension For Museum Exhibit**



**BULLOCK  
TEXAS  
STATE HISTORY  
MUSEUM**

*TheSTORYofTEXAS.com*

**Austin, Texas**

Summer 2018

# Proposed Move Area

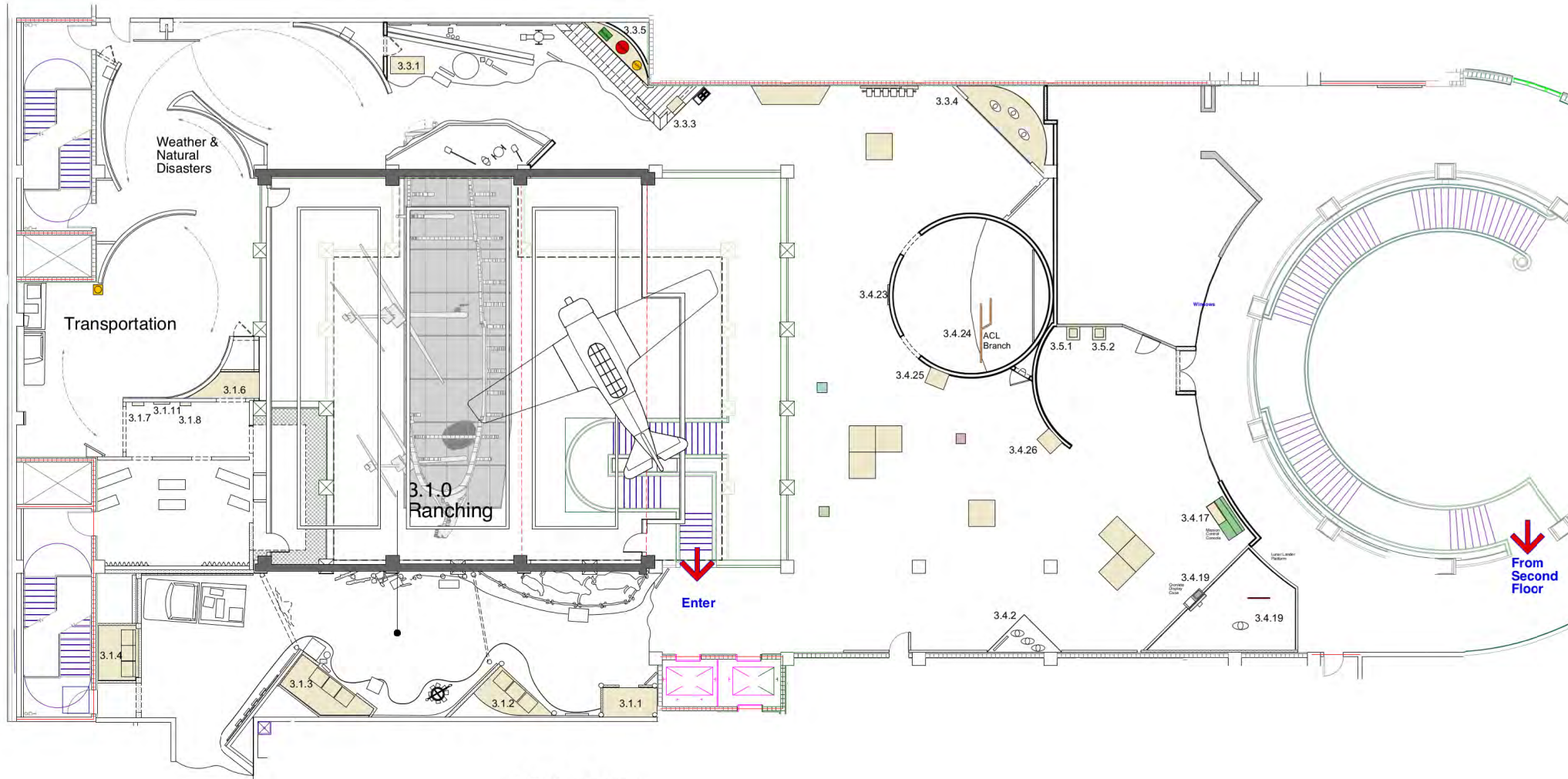

AT-6 move:  
version date: 3/31/17

Gantry Beam Concept - Layout on Catwalks

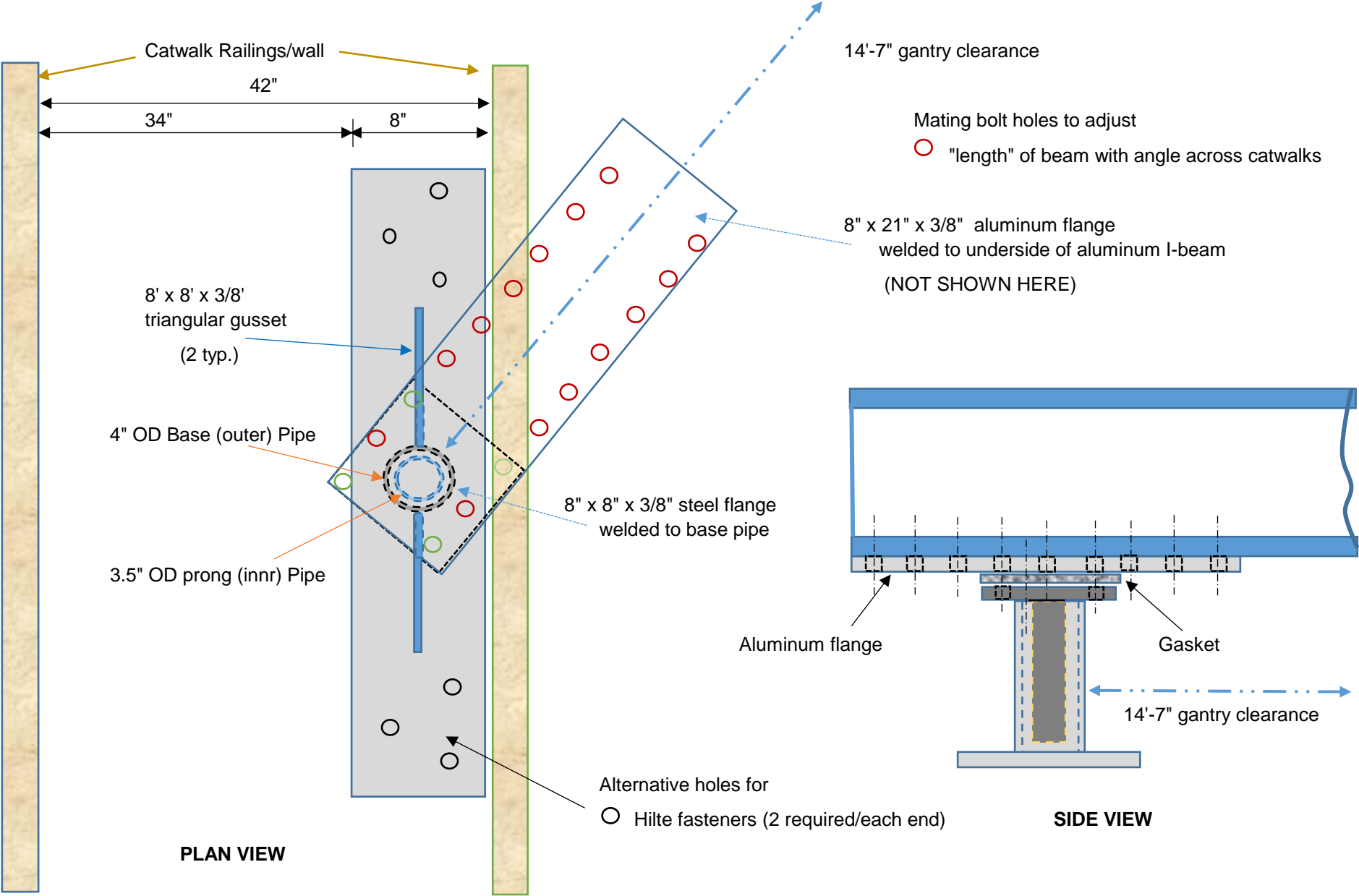

Beam Clamps-VER SALES, INC. - html.html

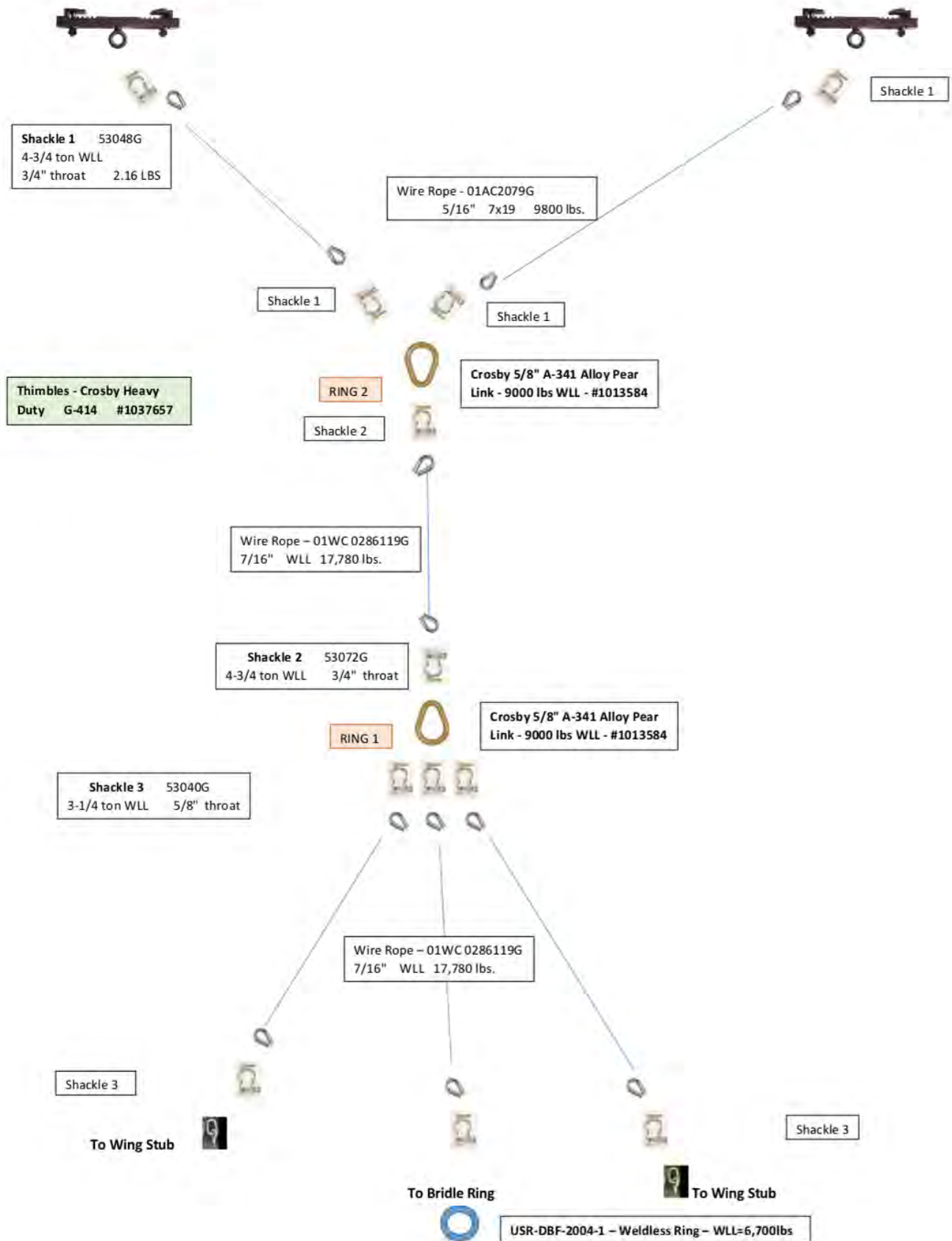

## Suspension Rigging for Aircraft

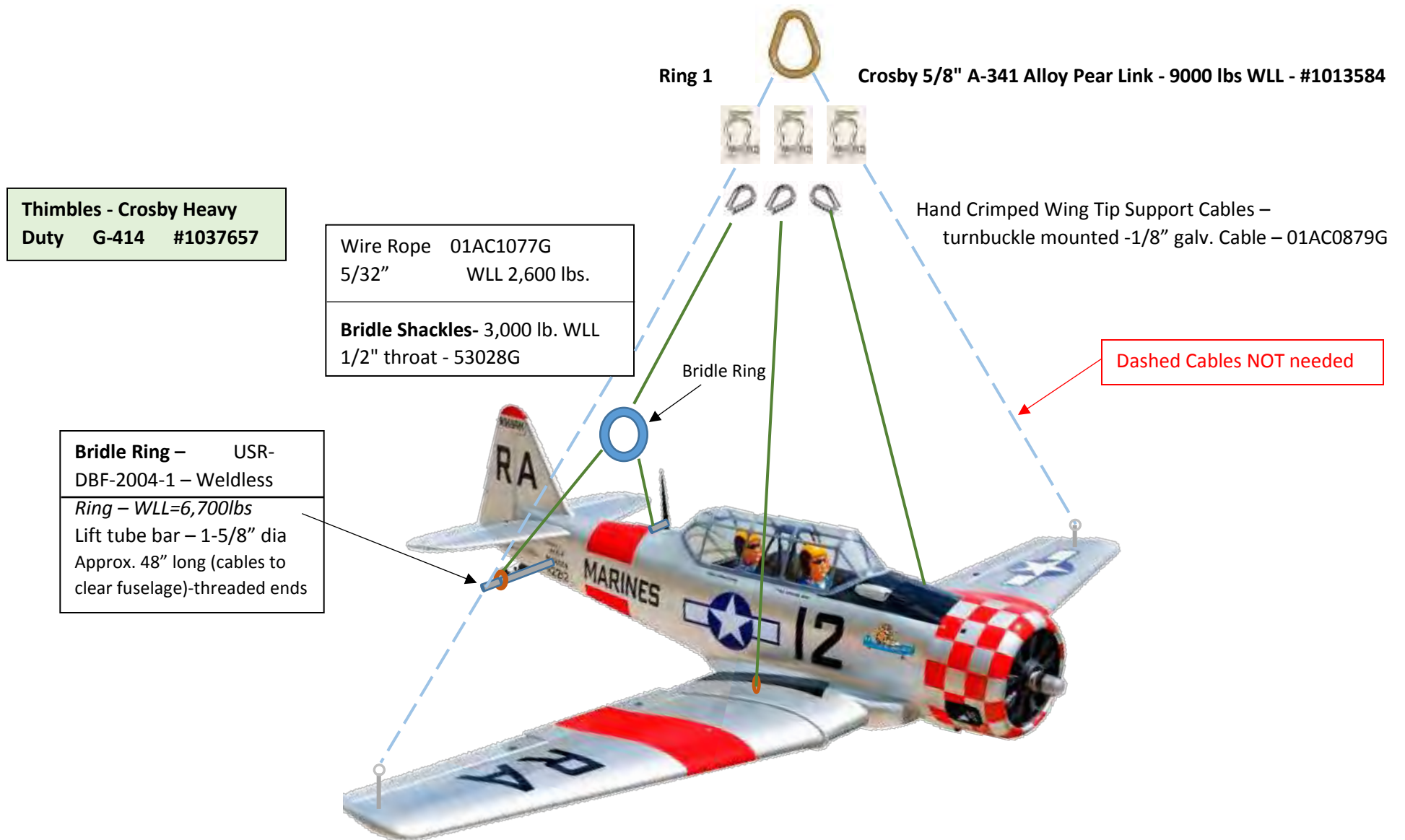





**Exhibit Before Suspension**

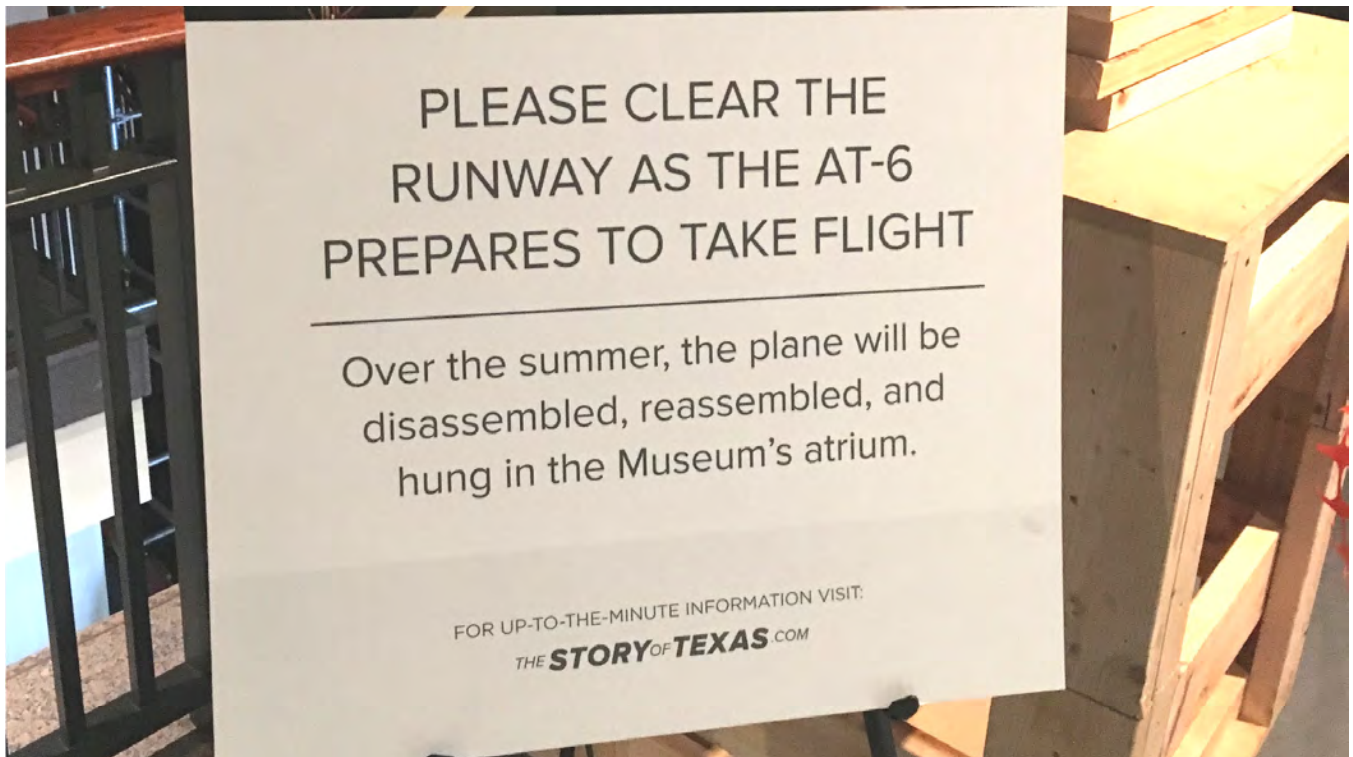



**Exhibit Before Suspension**



**Exhibit Before Suspension**





**Exhibit Before Suspension**



**This space over the atrium  
will be the new home  
for the AT-6 Texan.**







**Missing motor cowl was located and restored to match plane**



**Missing motor cowl was located and restored to match plane**



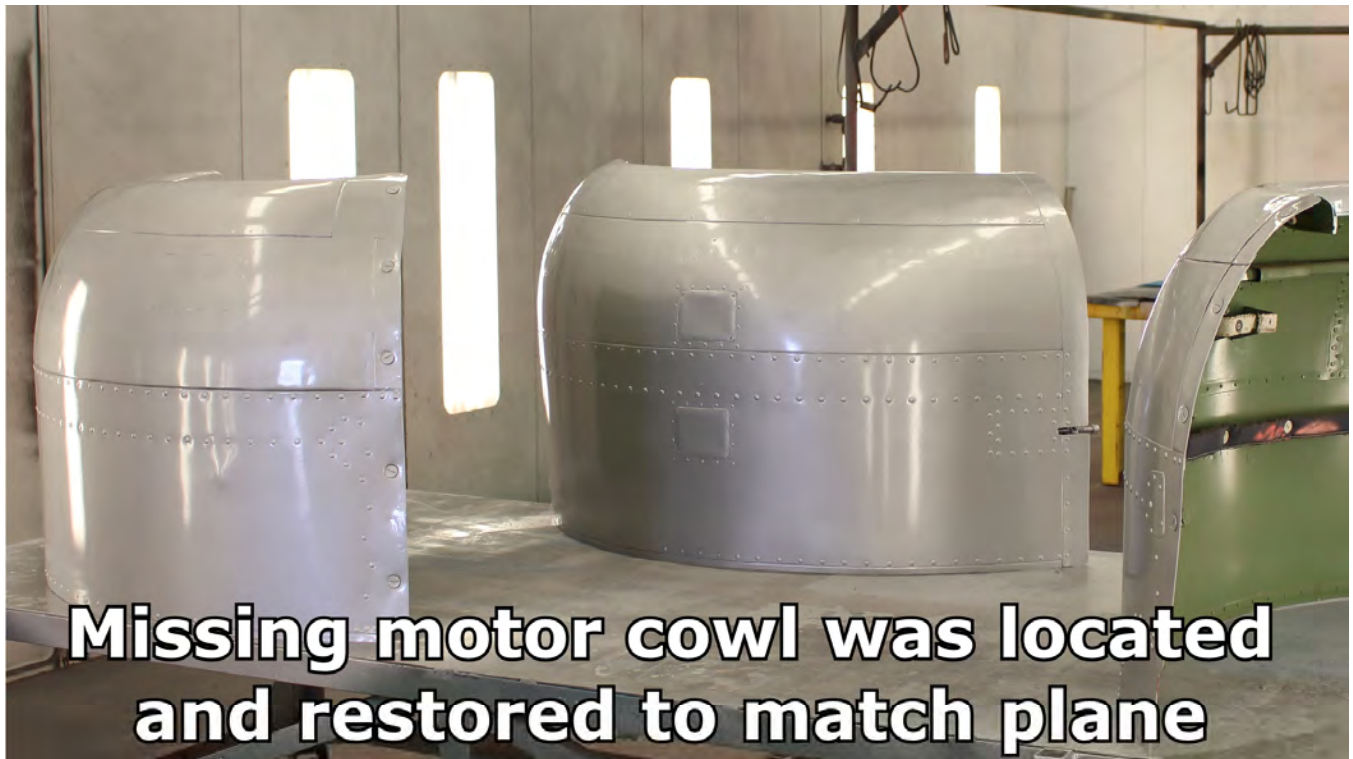

**Missing motor cowl was located and restored to match plane**

**Clegg Services manufactured a variety of parts and components needed to suspend the aircraft.**









**Supports & Beams being manufactured to suspend the aircraft.**

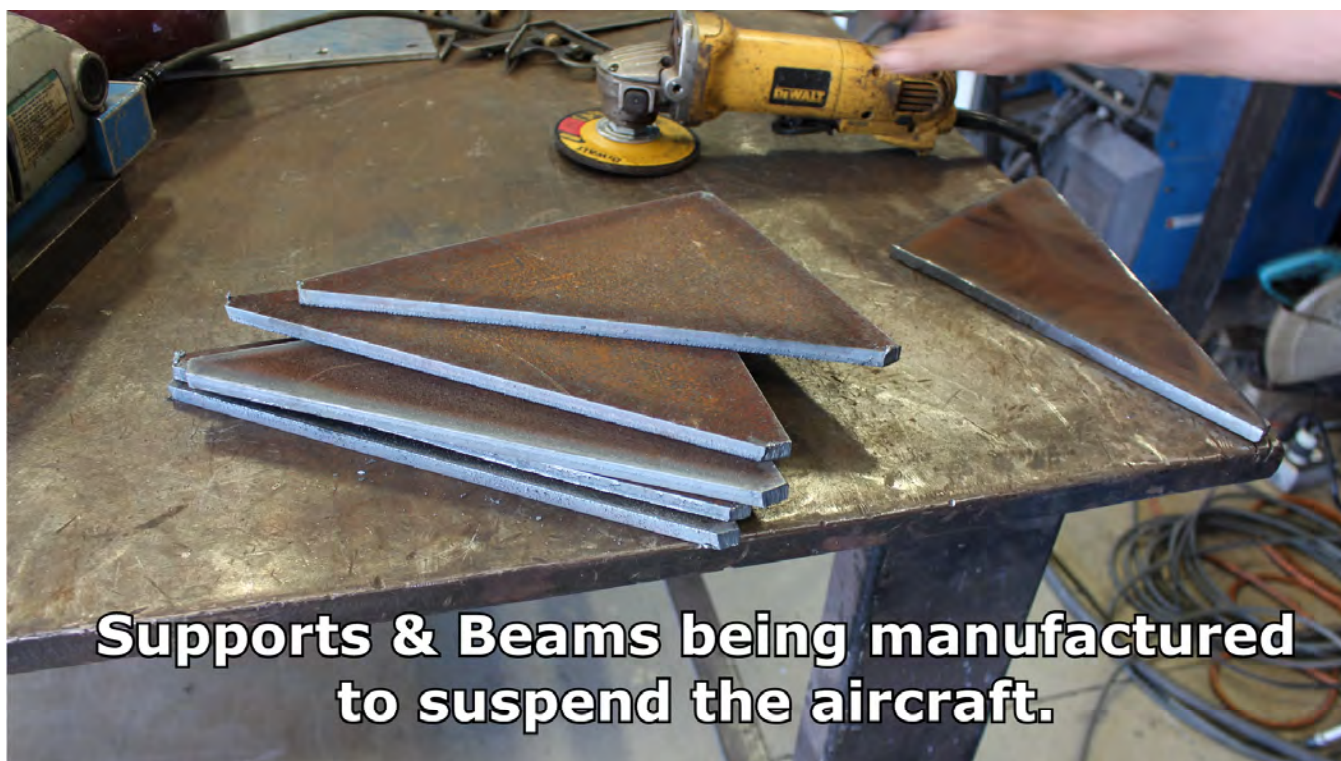

**Supports & Beams being manufactured to suspend the aircraft.**





**Supports & Beams being manufactured to suspend the aircraft.**



**Supports & Beams being manufactured to suspend the aircraft.**





**Supports & Beams being manufactured to suspend the aircraft.**



**Supports & Beams being manufactured to suspend the aircraft.**



**Supports & Beams being manufactured to suspend the aircraft.**



**Supports & Beams being manufactured to suspend the aircraft.**





**Supports & Beams being manufactured to suspend the aircraft.**



**Supports & Beams being manufactured to suspend the aircraft.**





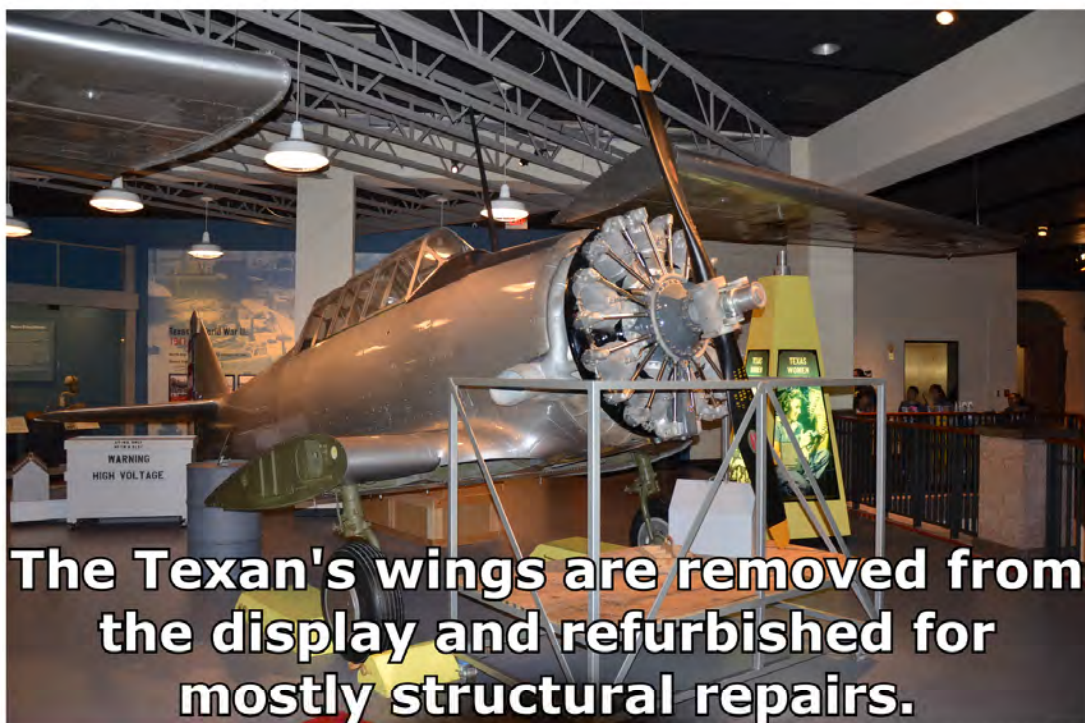

**The Texan's wings are removed from the display and refurbished for mostly structural repairs.**

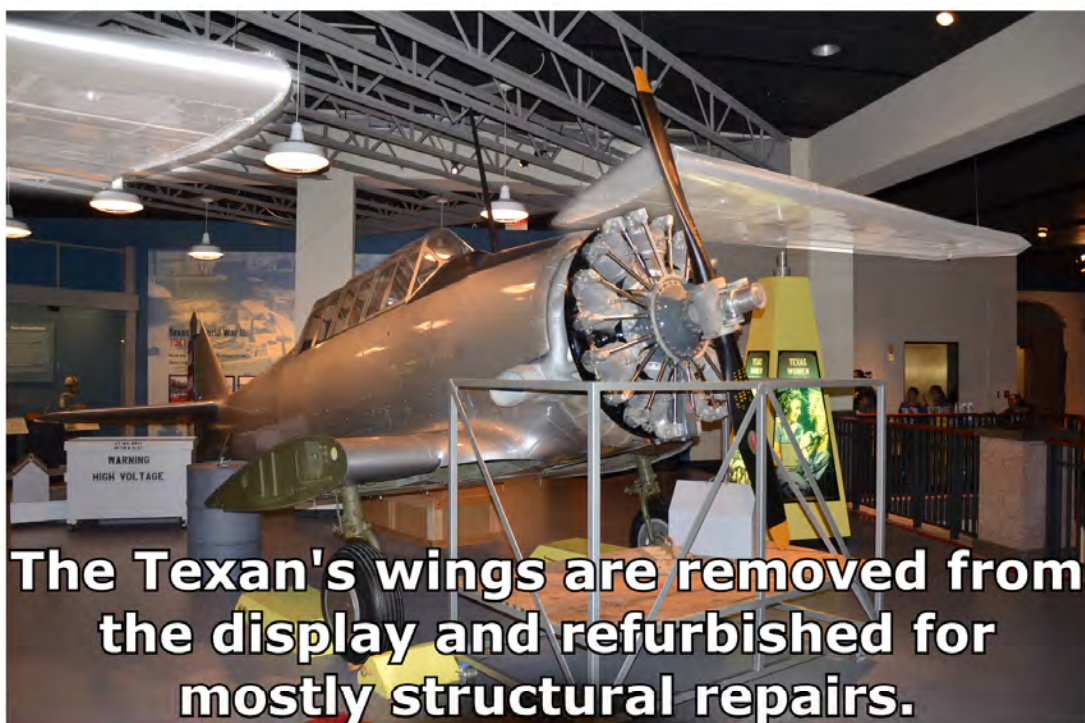

**The Texan's wings are removed from the display and refurbished for mostly structural repairs.**





**The Texan's wings are removed from the display and refurbished for mostly structural repairs.**



**The Texan's wings are removed from the display and refurbished for mostly structural repairs.**





**AT-6 motor is removed  
for another museum display  
and a replacement put in place.**



**AT-6 motor is removed  
for another museum display  
and a replacement put in place.**









**Protective covering being put in place.**



**Scaffolding installed to the third floor.**



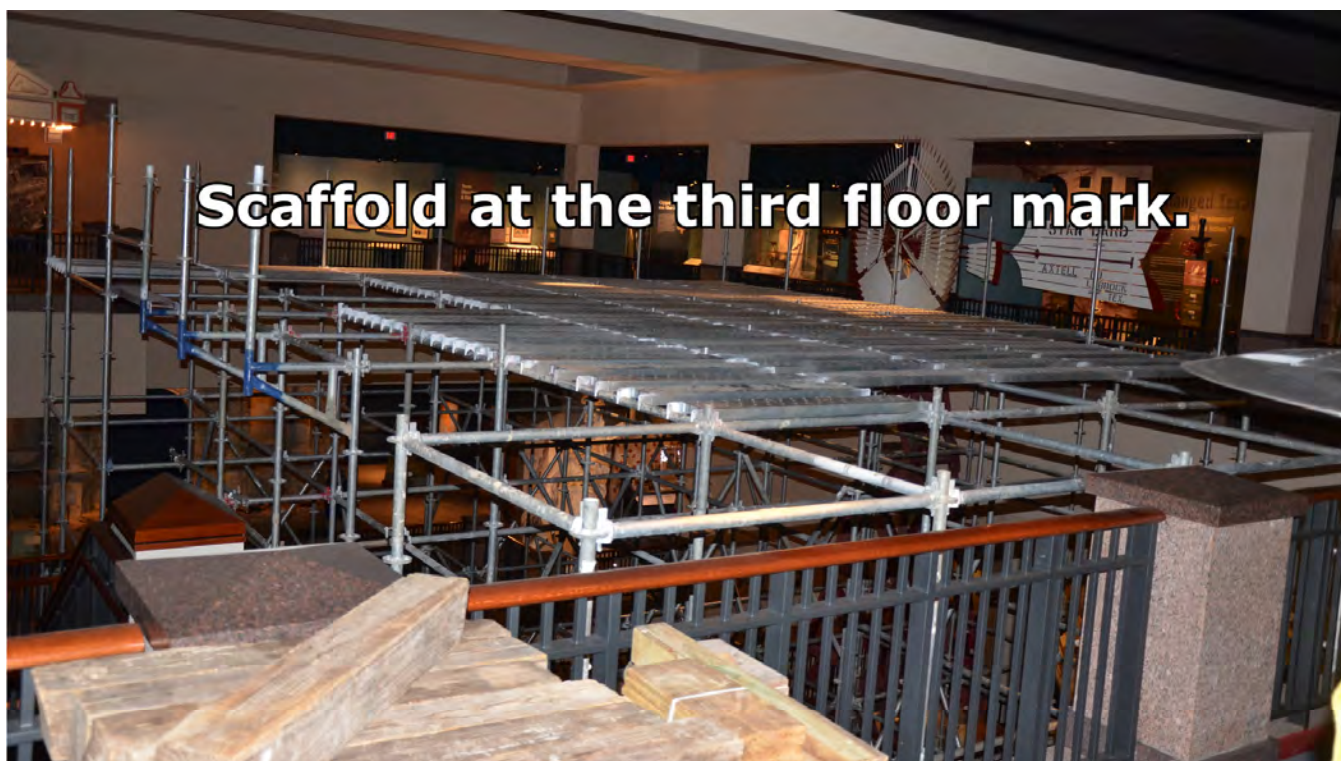
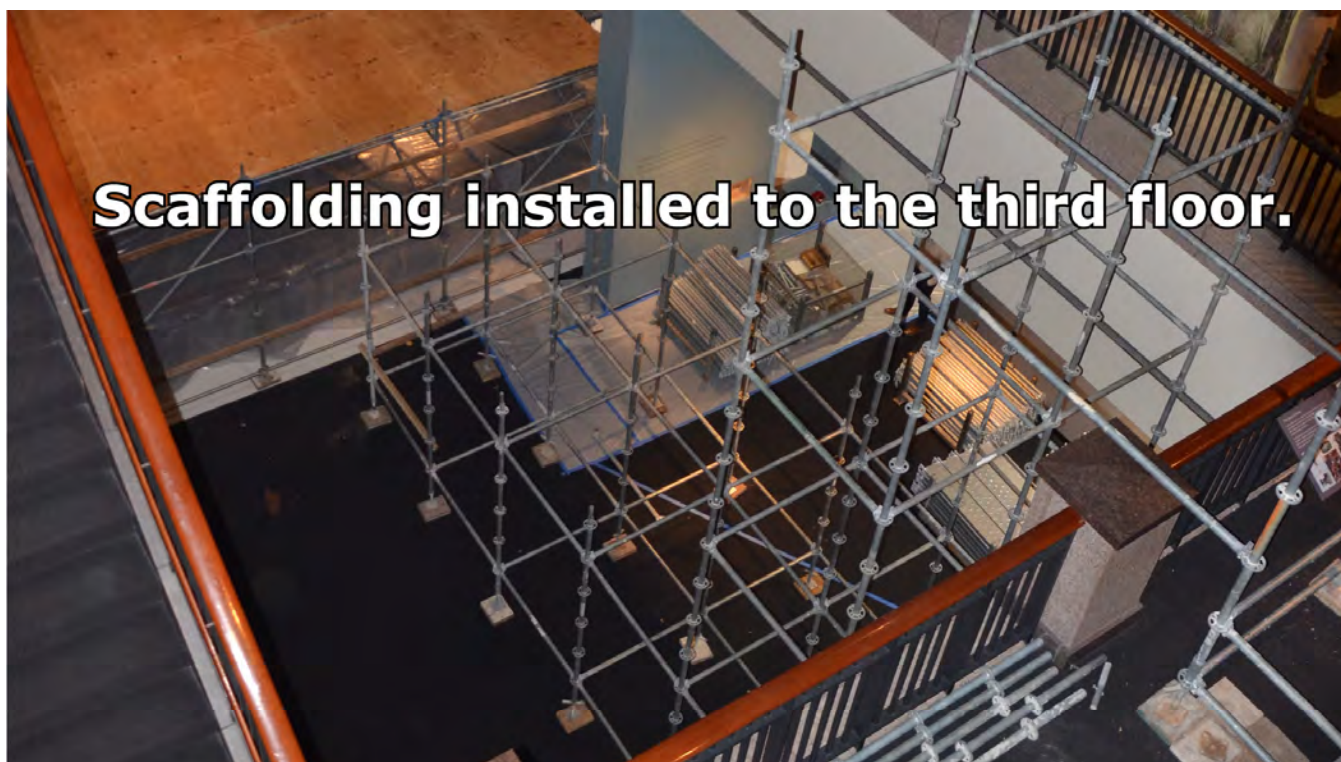



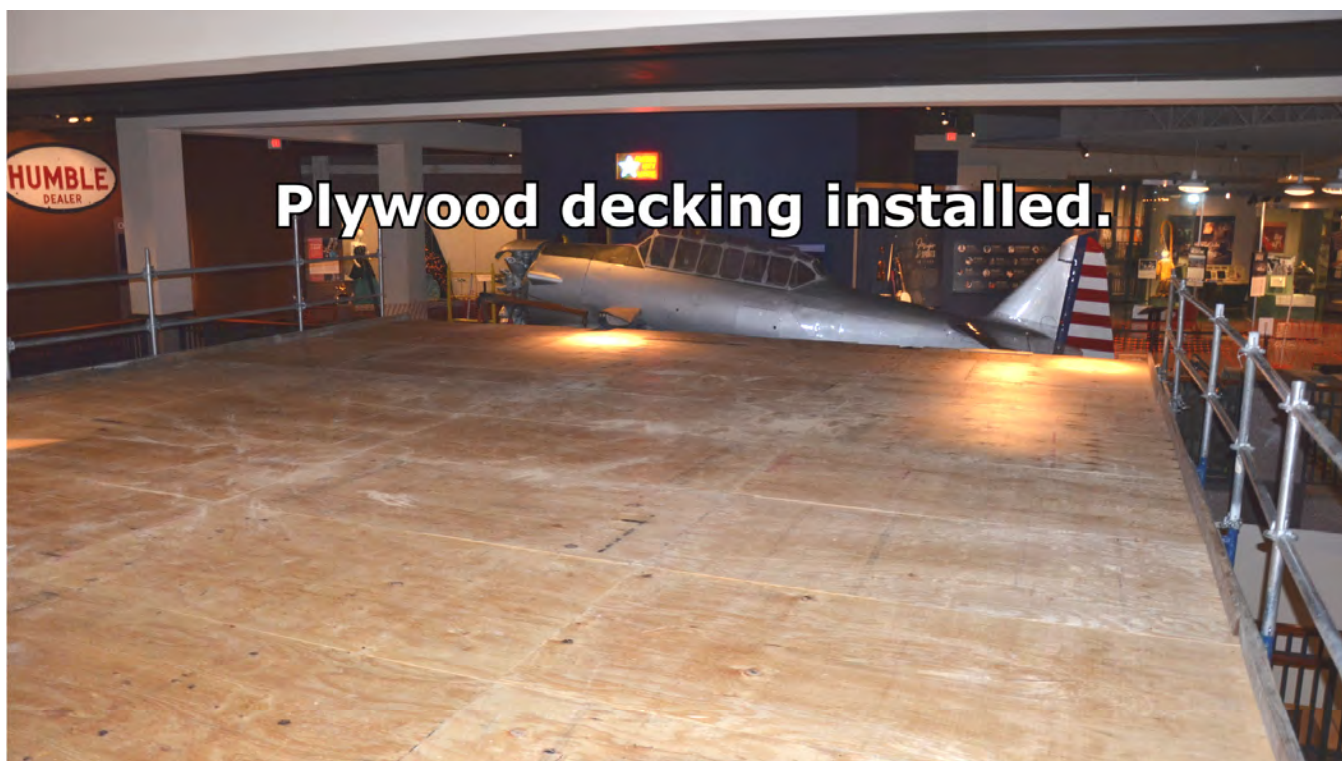
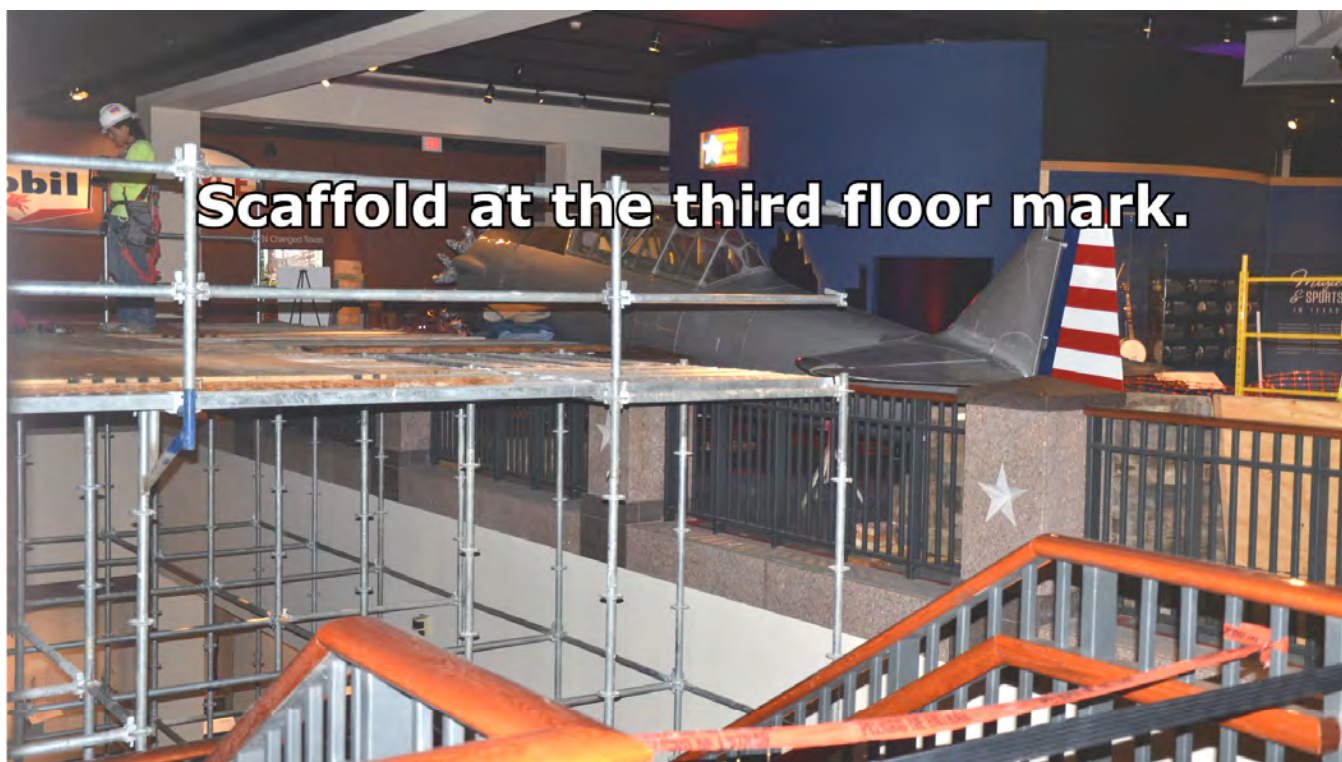

**Plywood decking installed.**



**The AT-6 Texan is lifted by  
two floor cranes.**





**Cribbing is added to reach height of railing.**







**Custom cradles with dollies  
rolls the AT-6 onto the  
scaffold platform.**



**Refurbished wings reinstalled**





**John Clegg & Part of the Clegg Services Staff.**







**Gantry Beams & Suspension Rigging Installation**





**Gantry Beams & Suspension Rigging Installation**







**Gantry Beams & Suspension Rigging Installation**







**Gantry Beams & Suspension Rigging Installation**







**Gantry Beams & Suspension Rigging Installation**



**Scaffolding Is Removed**



**Scaffolding Is Removed**







**Traditional Penny**

# The AT-6 Texan Takes Flight Over Bullock Museum's Atrium.

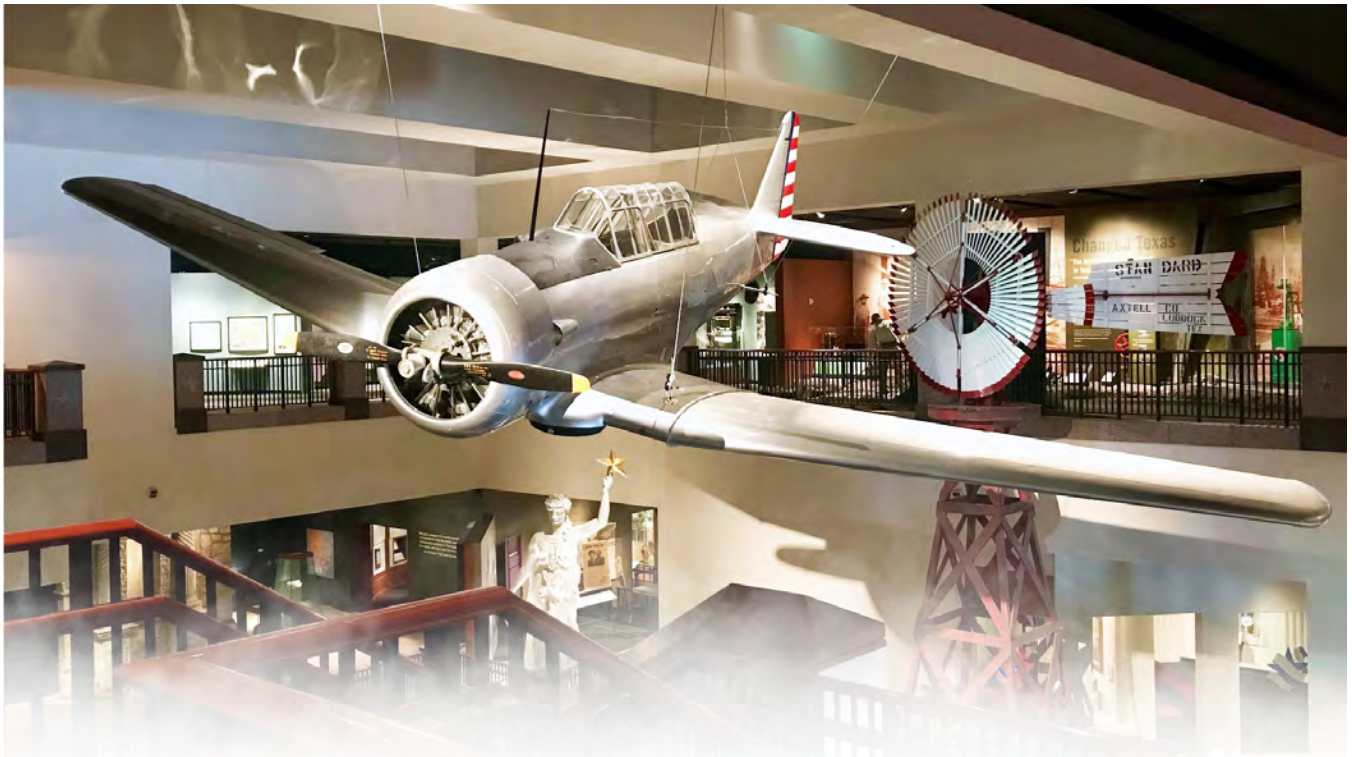











**Museum Staff Next to AT-6 Motor Display**

**The Clegg Services family would like to  
thank all the staff at the  
Bullock Texas State History Museum  
for trusting us with this amazing  
Texas historical project.**